

UNCONTROLLED IF PRINTED

Ra6.3 (G Ra0.4)

D
C
B
A

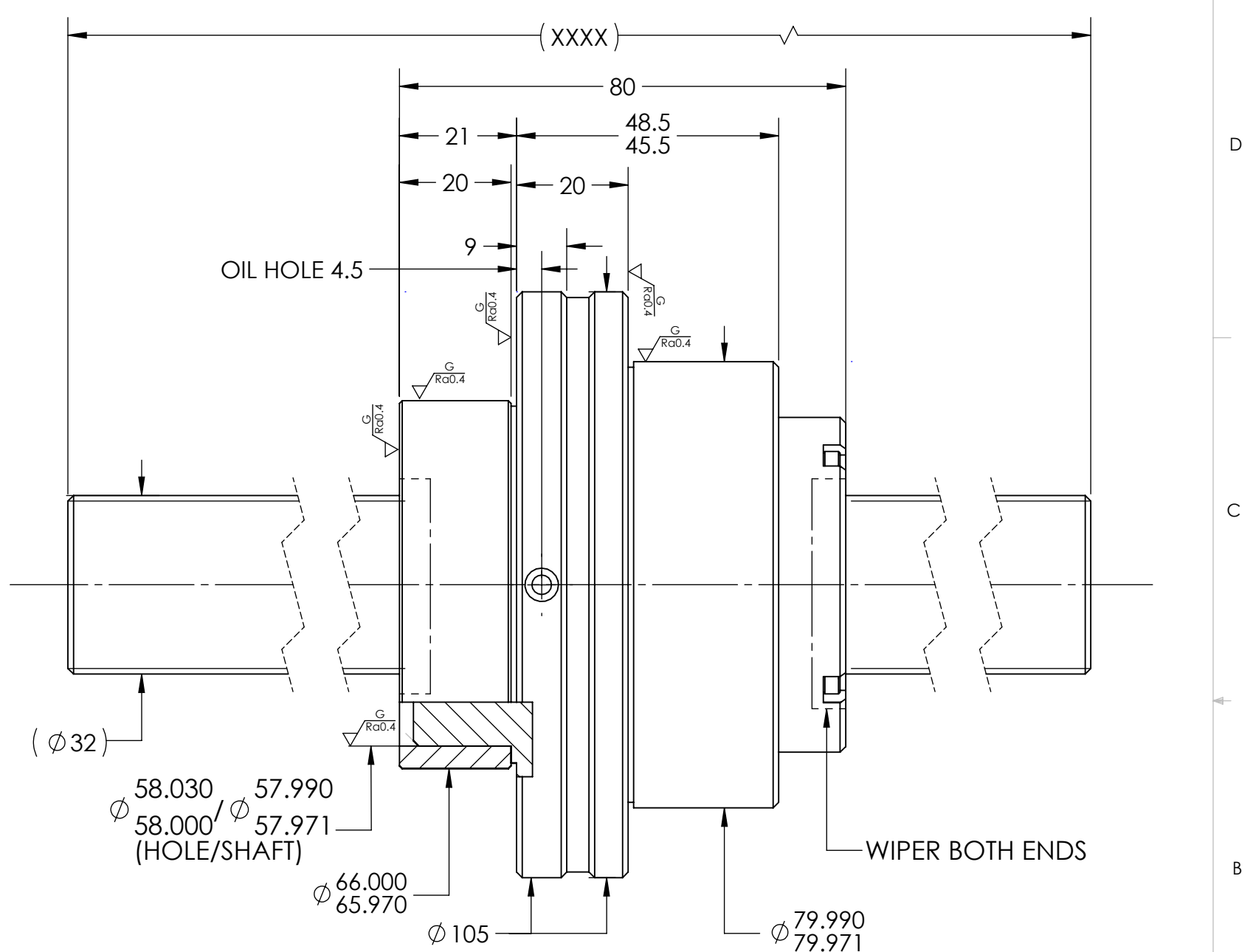
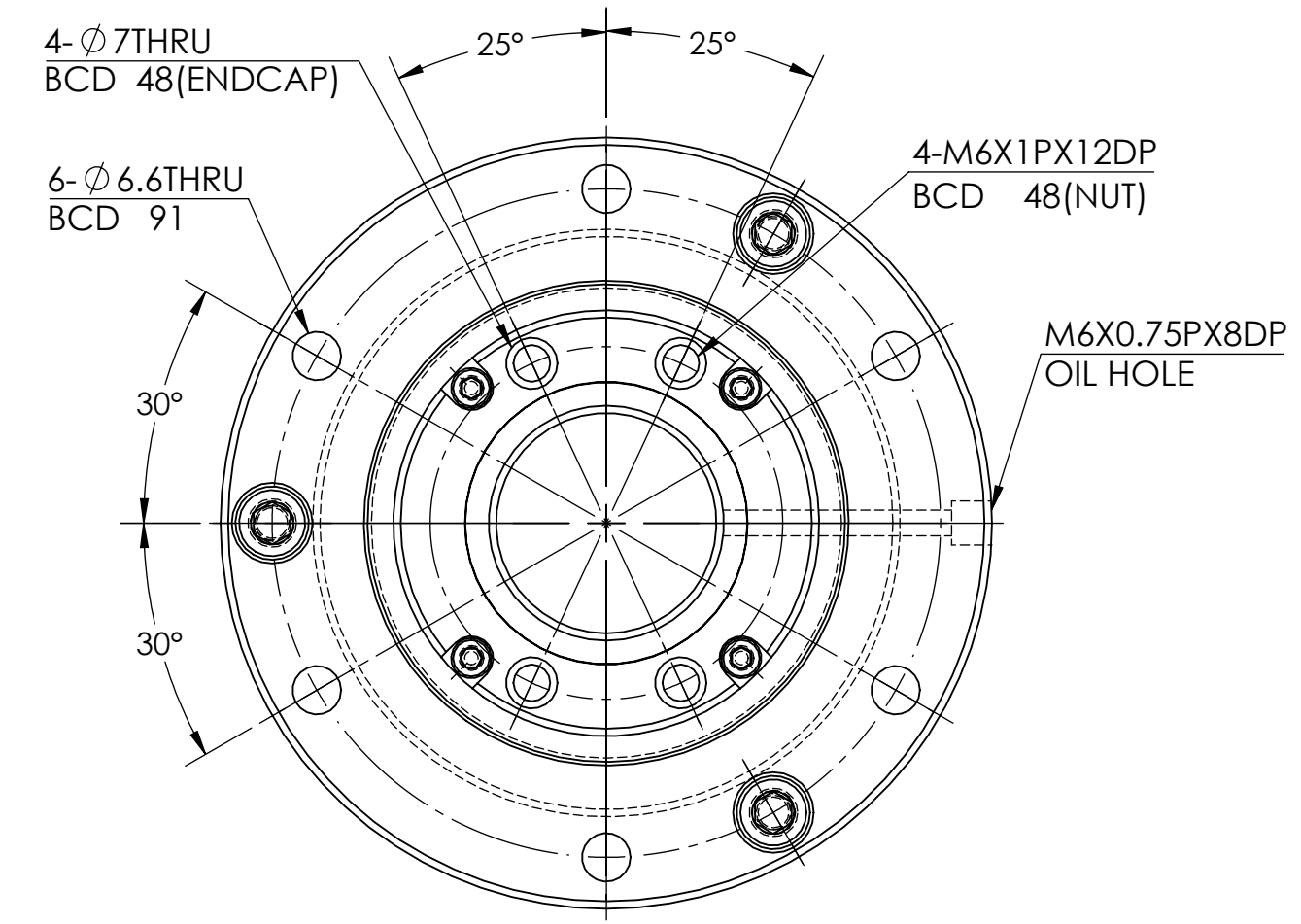

DYNAMIC (BEARING) (kgf)	3150
STATIC (BEARING) (kgf)	5035
PRELOAD(kgf)	~
R.D.	28.392
S.F. (kgf)	~
DRAG TRQ(kgf-cm)	~
TURN DIRECTION	R
P.C. DIA.	33.26
BALL DIA.	4.763
BACKLASH	0.05 MAX
CIRCUIT	1.8*2
LEAD ANGLE	17.03
DYNAMIC (kgf)	1840
STATIC (kgf)	5450
LEAD/PITCH	32/8

BREAK SHARP EDGES UNLESS OTHERWISE SPECIFIED									
ROUGH M/C	FIT M/C	GRD	MATERIAL		SHAFT:CF53/Equiv.				
6.3 a	1.6 a	0.4 a	NUT:SNM220/Equiv.		HRC 56-62				
THREAD BALL TRACK									
TOLERANCE mm									
UP	6	30	120	300	600	1200	2400	2400	
TO	6	30	120	300	600	1200	2400	OVER	
± 0.1	± 0.2	± 0.3	± 0.4	± 0.5	± 0.8	± 1.0	± 1.5		
DATE			INITIALS		HIWIN HIWIN CORPORATION				
DRAWN 01/19/2023			D.W.		12455 Jim Dhamer Dr, Huntley, IL 60142				
CHECKED 02/01/2023			T.C.		TITLE:				
MFG APPR. 02/01/2023			A.H.		STANDARD STOCK BALLSCREW				
PART NUMBER:									
4R32-32S2-DFSHR1-XXXX-XXXX-0.05									
SIZE	DWG. NO.	REV	SCALE						
B	W-SBS-32-32-A04	N/C	1:1						
v300p:	0.05								
ep:	0.750								

HIWIN CONFIDENTIAL

8 7 6 5 4 3 2 1